

LEGEND

WELLS
 ▲ WATER WELL
 △ DRY AND ABANDONED WILDCAT WELL

TYPICAL MAP RECORDING
 SMITH
 287
 3337

OWNER OF WELL
 LEASE NAME
 ELEVATION
 TOTAL DEPTH

WELL LOCATION MAP
 OF
ARKANSAS COUNTY
 PREPARED BY
 ARKANSAS DIVISION OF GEOLOGY
 RESOURCES AND DEVELOPMENT COMMISSION
 SCALE: ONE-HALF INCH=ONE MILE

TYPE	REVISIONS	DATE	BY
RELEASED	WELLS	APRIL 1981	J.L. McDONNELL
RELEASED	WELLS	JUNE 1986	BRAD BARNES
REVISIED	WELLS	AUG. 1, 1987	MARY A. DICKSON
REVISIED	WELLS	AUG. 1, 1988	MARY A. DICKSON
REVISIED	WELLS	SEPT. 15, 1989	LARRY WHITE
REVISIED	WELLS	JAN. 1, 1992	L.P. FELLOE
REVISIED	WELLS	JUNE 1970	DOVANA L. RINK
REVISIED	WELLS	SEPT. 28, 1976	B. BUTTERFIELD
REVISIED	WELLS	JUNE 6, 1979	B. BUTTERFIELD
REVISIED	WELLS	JAN. 10, 1991	B. CAPLAN

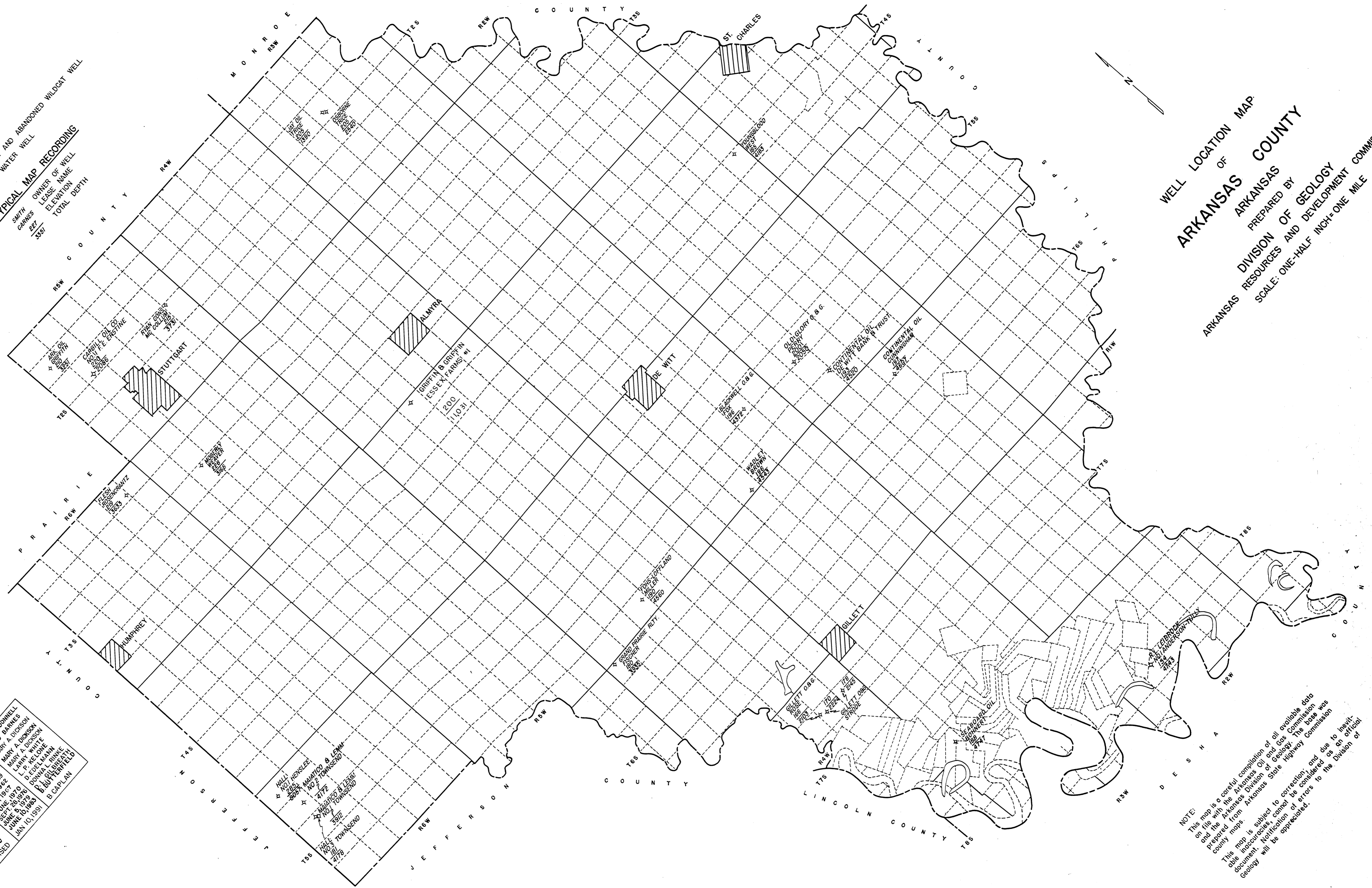

NOTE:
 This map is a careful compilation of all available data on file with the Arkansas Oil and Gas Commission and the Arkansas Division of Geology. The base was prepared from Arkansas State Highway Commission county maps.
 This map is subject to correction, and due to inevitable inaccuracies cannot be considered as an official document. Notification of errors to the Division of Geology will be appreciated.