

NOTE:

This map is a careful compilation of all available data on file with the Arkansas Oil and Gas Commission and the Arkansas Division of Geology. The base was prepared from Arkansas State Highway Commission county maps.

This map is subject to correction, and due to inevitable inaccuracies, cannot be considered as an official document. Notification of errors to the Division of Geology will be appreciated.

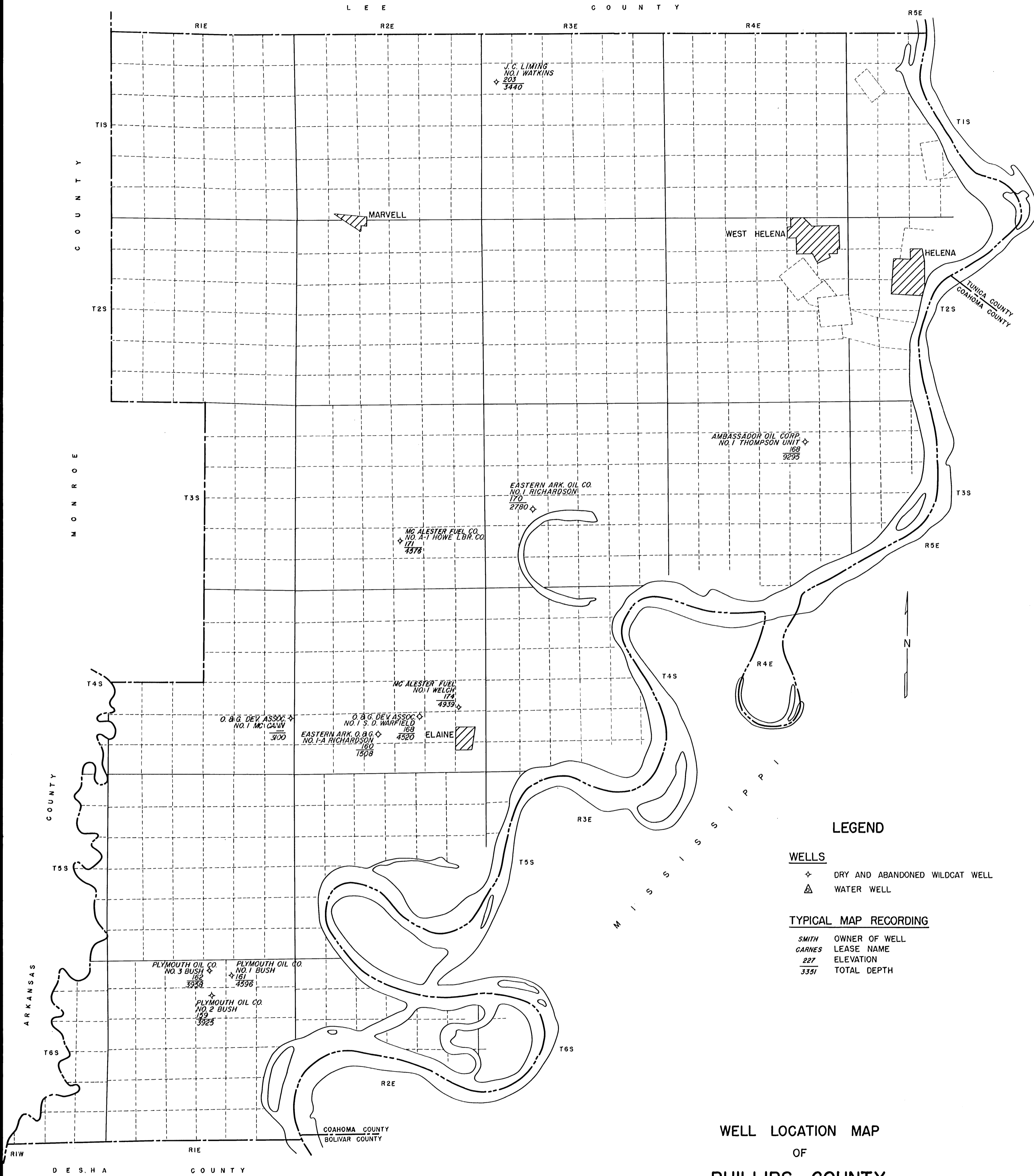

LEGEND

- WELLS**
- ◆ DRY AND ABANDONED WILDCAT WELL
 - △ WATER WELL

TYPICAL MAP RECORDING

- SMITH OWNER OF WELL
- CARNES LEASE NAME
- 227 ELEVATION
- 3331 TOTAL DEPTH

WELL LOCATION MAP
OF
PHILLIPS COUNTY
ARKANSAS

PREPARED BY
DIVISION OF GEOLOGY
ARKANSAS RESOURCES AND DEVELOPMENT COMMISSION
SCALE: ONE-HALF INCH=ONE MILE

TYPE	DATE	BY
RELEASED	APRIL, 1951	J. L. MC DONNELL
WELLS	JUNE, 1956	MARY DICKSON
WELLS	AUG. 1, 1957	MARY A. DICKSON
WELLS	AUG. 1, 1958	MARY A. DICKSON
WELLS	SEPT. 15, 1959	MARY A. DICKSON
REVISED	JAN., 1982	LARRY WHITE
REVISED	AUG., 1987	DANA BUNCH
REVISED	JUNE, 1970	D. EDELMANN
REVISED	OCT. 5, 1976	DONNA L. RINKE
REVISED	JUNE 5, 1979	D. L. GILBREATH
REVISED	JUNE 10, 1983	B. BUTTERFIELD

PHILLIPS COUNTY